

02 Series

Electrified Powerbolts

IPIXA Security 02 Series Electrified Powerbolts represents reliable and cost effective Access Control solution

GF series offers electrified locks designed specifically for fully frameless glass doors with door leaf as well as frame - both made of glass. The locks are equipped with sensors to remotely monitor the status of the door. The minimum maintenance feature & 3 years limited warranty on all models enables this range to be ideal for commercial applications.



AEL0201.GF

Product Specifications

Type	: Fail Safe - Power to Lock
Holding Force	: 2000 lbs
Operating Voltage	: 12/24 VDC
Current Draw	: Start Current 1200 mA Standby Current 150 mA
Door Status Monitoring	: Inbuilt Door Status Monitoring
Operating Temperature	: - 10°C - + 55°C
Weigth	: 0.7 kg
Dimension	: Face Plate - 146 L x 43 W x 39 H (mm) Bracket - 146 L x 43 W x 25 H (mm) Bolt - 12.5mm Diameter,15mm Throw
Cycle Testing	: 500,000 Cycles
Special Features:	: Suitable for 180 degree in-swing, out-swing or sliding Fully Frameless Glass Doors (10~14 mm thickness) Design incorporating in-built U brackets Relock Delay Timer with 3 options: 0 / 2.5 / 5 seconds Back EMF Prevention

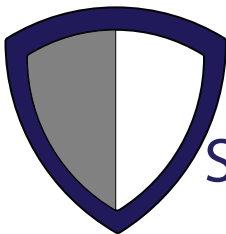
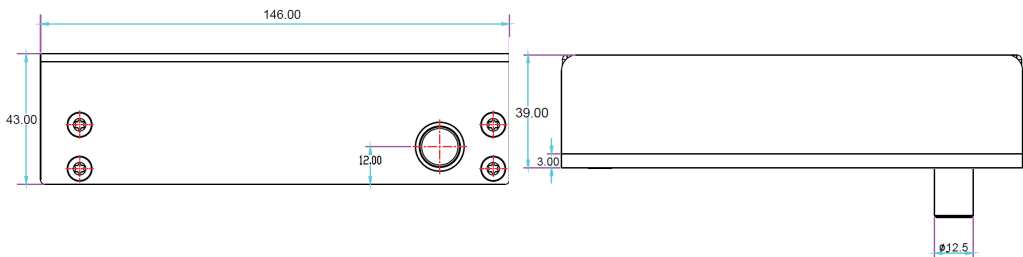

IPIXA
SECURITY

3
YEARS
WARRANTY

IPIXA SECURITY LIMITED
Kemp House, 160 City Road,
London, EC1V 2NX,
United Kingdom
ipixa.co.uk